

Mobile Thermal Printer
MPT-III

User Manual

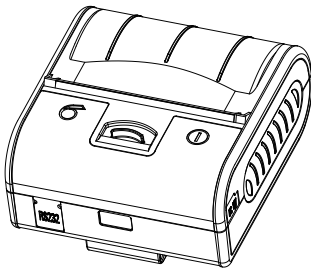

Xiamen Hanin Electronic Technology Co.,Ltd.

ADD: Room 305A, Angye Building, Pioneering Park,
Torch High-tech Zone, Xiamen, China 361009
TEL: +86—(0)592-5885993
FAX: +86—(0)592-5885992
WEB: www.hpert.com

Contents

Precautions.....1
1. Safety Precautions.....1
2. Operation Precautions.....1
3. Storage Precautions.....2
4. Battery Safety Precautions2
Chapter 1 Brief Introduction4
1.1 Appearance4
1.2 Accessories4
Chapter 2 Specifications5
Chapter 3 Operation Methods.....6
3.1 Preparation Before Using6
3.1.1 Li-ion Battery Loading6
3.1.2 Paper Loading6
3.2 Basic Function.....6
3.2.1 Printer On6
3.2.2 Printer Off7
3.2.3 Self-test7
3.2.4 Paper Loading7
3.2.5 Battery Charging7
3.3 Interface and Printing8
3.3.1 Serial Interface8
3.3.2 Infrared Ray(IR)&IrDA Interface8
3.4 LED Indicator and Buzzer Definition9
3.5 Software Tools of MPT-III9
Chapter 4 Other Information10
4.1 Printer Technical Manual10
4.2 Preprinted Black Mark Specification.....10

► Precautions

⚠ 1.Safety Precautions

- 1) Be sure to use the specified battery and power source provided by our company. Connection to an improper power source may cause fire, explosion or damage to the printer.
- 2) Don't put the battery into fire or water, don't disassemble or modify the battery, don't be short circuit, otherwise may result in injury or fire or even explosion.
- 3) If the printer would not be used for a long time, be sure to take off the battery, otherwise the battery may leak liquid which is corrosive, if improper operation causes battery leak, and the liquid is spattered on the skin or clothes, please wash it with water, if spattered into the eyes, please rinse them with water thoroughly and see a doctor.
- 4) Please do not open the paper case cover when it is printing or just when printing is over, do not touch the print head with hand or body, overheat may cause scald.

⚠ 2.Operation Precautions

- 1) Water or other liquid should not spill into the printer, also the printer should not be expose to the rain, or else may cause printer damage.
- 2) Please do not open the paper case cover when it is printing, otherwise the printer may work improperly.
- 3) If print with serial interface, should not unplug the interface cable in the course of printing, or else some printing data may be lost.
- 4) When print in Ir or IrDA mode, be sure the Ir window of the host equipment face rightly the Ir window of the printer, the distance should be within the range of 50cm, and the angle should be within the range of 30 .
- 5) When print with Bluetooth interface, the communication distance should be within 10 m eters, otherwise the printer doesn't print or prints rubbish codes.
- 6) Too high (40°C) or too low (0°C) temperature and too high (85%) or too low (20%) relative humidity both effect the print quality.
- 7) The print paper in poor quality or stored for too long time also may reduce the print quality even damage the printer.
- 8) In the black mark detecting mode, the printer requires that the

preprinted black mark is accordant with the black mark specifications (details please refer to 4.2), otherwise the black mark can not be detected correctly.

9) Be sure to use up the power of the battery before charge it, as it can ensure the using life of the battery.

⚠ 3.Storage Precautions

- 1) The printer should be placed in such an environment that the temperature is between -20℃ and 70℃, and the relative humidity is between 5% and 95%.
- 2) If the printer will be stored for a long time, pleas be sure to take out the battery, otherwise may damage the battery and printer.
- 3) Normal thermal paper can't be kept too long, if you need to keep the receipt for a long period, please choose long term effective thermal paper.
- 4) The print paper should be keep away from high temperature environment and point-blank sunshine.

⚠ 4.Battery Safety Precautions

Be sure to read the user manual carefully before using the product. Ignore the following instructions may cause battery overheating, fire, explosion, damage and/or performance, and reduced product life.

- 1) Do not allow water, sea water from entering or leaking into the battery. If the batteries internal safety device burn, when charging it, it may produce abnormal current and/or voltage, or abnormal chemical reaction when charging it, then may cause the battery overheating, fire and / or explosion.
- 2) Do not use or place the battery nearby the stove or other high temperature places. Excessive heat maybe damage the resin shell and/or the insulation materials, there by cause short-circuit inside the battery, then the battery may be overheated, burning and/or explosion.
- 3) When charging, use a specified charger. Other conditions (high temperature, high pressure/high current, using the modified battery charger,etc.) excluded here may result in overcharging the battery and abnormal current and/or voltage, cause abnormal chemical reaction , and may cause the battery overheat, lightand/or explosion.
- 4) Battery clearly marks with positive and negative. When connect the battery with the charger and/or printer, be sure to verify the correct battery orientation. Reverse insertion will cause the reverse charging and may cause

abnormal chemical reaction, and then may cause the battery overheat, ignite, and /or explosion.

- 5) Do not make the battery contact with the power outlet and/or car cigarette lighter socket. This may cause high pressure and excessive current , and lead to the battery overheat, burning and/or explosion.
- 6) Do not heat the battery or put the battery into fire. This may melt insulation material and/or damage safety devices or safety equipment, then ignite electrolytic solution , and cause the battery overheat, burning and/or explosion.
- 7) Do not use the battery with contrary (+) and (-) location. In the charging process, this will cause the reverse charging and may cause abnormal chemical reaction. During use, may appear unpredictable current exception, and cause the battery overheat, ignite, and/or explosion.
- 8) Do not make the battery (+) and (-) contact with any metal. Also, do not carry along or store batteries with metal objects, such as necklaces, hair clips and so on. Battery internal short circuit may cause excessive current, and lead to the battery overheat, ignite, and/or explosion and the adjacent metal objects(necklaces, hairpins, etc.) may be overheating.
- 9) Do not throw or attack the battery heavily. If internal safety device of the batteries burn, the battery charging may cause any abnormal current and/or voltage, and abnormal chemical reaction, and lead to the battery overheat, ignite, and/or explosion.

► Chapter 1 Brief Introduction

1.1 Appearance

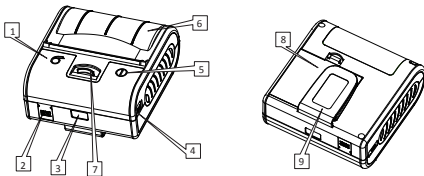

- 1) Feed On/Off and Blue Status Indicator
- 2) RS232 Serial Interface
- 3) Infrared Ray(IR) Interface(optional)
- 4) Power Input
- 5) Power On/Off and Red Power Indicator
- 6) Top Cover
- 7) Cover Open Button
- 8) Li-ion Battery Cover
- 9) Buckle

1.2 Accessories

■ Standard accessories

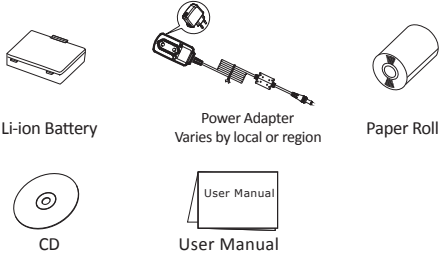

■ Optional accessories

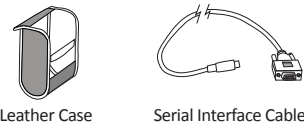

➤Chapter 2 Specifications

	Item	Parameter
Printing	Printing Method	Direct Thermal Line Printing
	Resolution	203dpi (8dots/mm)
	Printing Speed	Max.70mm/s
	Valid Printing Width	72mm
	Interface	RS232, USB (optional)
Power Saving	Sleep Mode	YES
Resident Fonts	Chinese	GBK 16×16, 24×24dots
	Alphanumeric	ASCII 8×16, 12×24dots
	User-defined	YES
	Codepage	46
Barcode	1D	UPC-A, UPC-E, EAN8, EAN13, CODE39, ITF, CODEBAR, CODE128, CODE93
	2D	QR code
Graphics		Support bitmap printing with different density and user defined bitmap printing (Max. 40K for per bitmap, and Max. 64K for total)
Detection	Sensors	Paper out detection, cover open detection
LED Indicator	Power Indicator	Red
	Error Indicator	Blue
Power	Power Supply	12V===1.0A
	Battery	1500mAh/ 7.4V rechargeable Li-ion battery
Paper	Paper Type	Receipt paper
	Paper Width	80mm
	Paper Thickness	0.05~0.12mm
	Paper Roller Diameter	≤40mm
	Paper Loading	Easy loading mechanism
Physical Characteristics	Working Condition	0℃~40℃ , 20%~85%RH
	Storage Condition	-20℃~70℃, 5%~95%RH
	Dimension	102.5(L)*110(W)*50(H)mm
	Weight	325G (Without paper roll)
Software	Emulation	ESC/POS
	Driver	Windows XP/Vista/Win7/Win8/Win10
	SDK	WinCE, Win Mobile, Android

adapter, otherwise cause to printer damage and battery leakage, light and/or explosion.

3.3 Interface and Printing

3.3.1 Serial Interface

This model of printer uses DB-9 serial interface cable (one end is D model standard serial interface socket, connected to host computer, the other end is PS/2 socket, connected to printer).

3.3.2 Infrared Ray (IR) & IrDA Interface

MPT-III can be connected to your main device through IR, RAW-IR and IrDA can not be available at the same time. Reset the printer if it is not the model you want. When printing through RAW-IR and IrDA, make infrared ray of main device right towards to infrared ray window of printer, distance should be less than 50mm (varies with main device), angel should be less than 30°.

➤Chapter 3 Operation Methods

3.1 Preparation Before Using

3.1.1 Li-ion Battery Loading

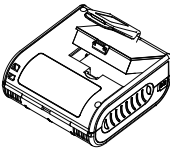

- 1) Refer to the picture, put the battery in the battery slot, pls pay attention to the correct positive and negative.
- 2) Close the battery case.

3.1.2 Paper Loading

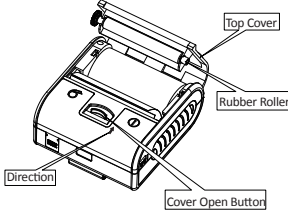

- 1) Pull to open the top cover.
- 2) Put the paper into the paper case, pay attention to the direction of the paper. If loaded reversely, it won't print.
- 3) Pull paper out of paper case.
- 4) Make sure paper in the center then close top cover.

3.2 Basic Function

3.2.1 Printer On

The printer is powered on by pressing the power button; the power indicator is on with red color whenever the printer is on.

Notice: when the battery is almost exhausted, the LED

indicator blinks with blue color, in this case, you must charge the battery by using the adaptor. The method of charging the battery, please refer to 3.2.5.

3.2.2 Printer Off

The printer is off after press the [POWER] button last for 2 seconds. All the indicators are off whenever the printer is off.

3.2.3 Self-test

The self-test checks the printer's current settings, status and whether the printer has any problem. Hold down the [FEED] button while press [POWER] button about 3 seconds, the selftest begins.

The printer is ready to receive data as soon as it completes the self-test.

3.2.4 Paper Feeding

When printer works under non-blackmark mode, user could use [FEED] button to feed paper manually. Printer will stop feeding when reaching max feeding distance. Max feeding distance could be set by the PC software "MPTTools", please refer to your distributor for more technical information of "MPTTools".

3.2.5 Battery Charging

When li-ion battery runs out of power, blue LED indicator flash slowly and buzzer will give up warning. It will power off automatically when continues printing. If you want to go on, please charge it.

Charging method: Plug in socket (220V, 50Hz) with power adapter.

1) Power-off charging : LED light will always indicate blue color and goes off when fully charged.

2) Power-on charging: LED light will keep blinking in blue color, and will stop blinking when fully changed. Printer could be in use when charging.

Notes: Please use the manufacturers supplied battery and power

3.4 LED Indicator and Buzzer Definition

There are one buzzer and two LED indicators to indicate the printer status. LED indicators indicate current status and buzzer indicates the changes of status.

Status Indicator (Blue)	Power Indicator (Red)	Buzzer	Status
ON	OFF	Once	Power-on, ready
Flash	Flash	Twice	Cover open
Flash	Flash	Once	Paper end
Flash	OFF	Silent	Standby
OFF	Flash	Once	Power-on charging
OFF	ON	Silent	Power-off charging
OFF	ON	Three times	Power-on charging, battery full
OFF	OFF	Silent	Power-off charging, battery full
ON	OFF	Once	Press [FEED] button
OFF	OFF	Twice	Power off

3.5 Software Tools of MPT-III

There is software which called MPTTools. It's software to set the printer parameters, it used to set the baud rate of serial port, Infrared mode, RAW-IR and VIR, it also support setting the printer Bluetooth device name and password. The instructions pls refer to MPTTools Guide.

➤Chapter 4 Other Information

4.1 Printer Technical Manual

Pls refer to MPT-III Series technical manual.

4.2 Preprinted Black Mark Specification

If user wants to locate receipt by detecting preprinted black mark, it shall accord to the following specification for the black mark, otherwise it may cause printer can't recognize the black mark.

1) Printing position: black mark shall preprint at the left side of receipt.

2) Width range: ≥7mm

3) Height: 4mmsheight≤6mm

4) Reflection rate to IR: <10% (reflection rate to the black mark on paper>65%)

5) Hps: Hps indicates the distance from down edge of detecting mark from beginning line. (0mm≤Hps≤1mm)

